

➤ PROJEKTDATEN

ORT

Hannover

ARCHITEKTEN

saboARCHITEKTEN BDA
Freier Höpfinger Steinweg Partnerschaft mbB
mit KISSERARCHITEKTUR

FERTIGSTELLUNG

Frühjahr 2015

BRUTTOGESCHOSSFLÄCHE

155 m²

WOHNFLÄCHE

117 m²

BRUTTORAUMINHALT

322 m³

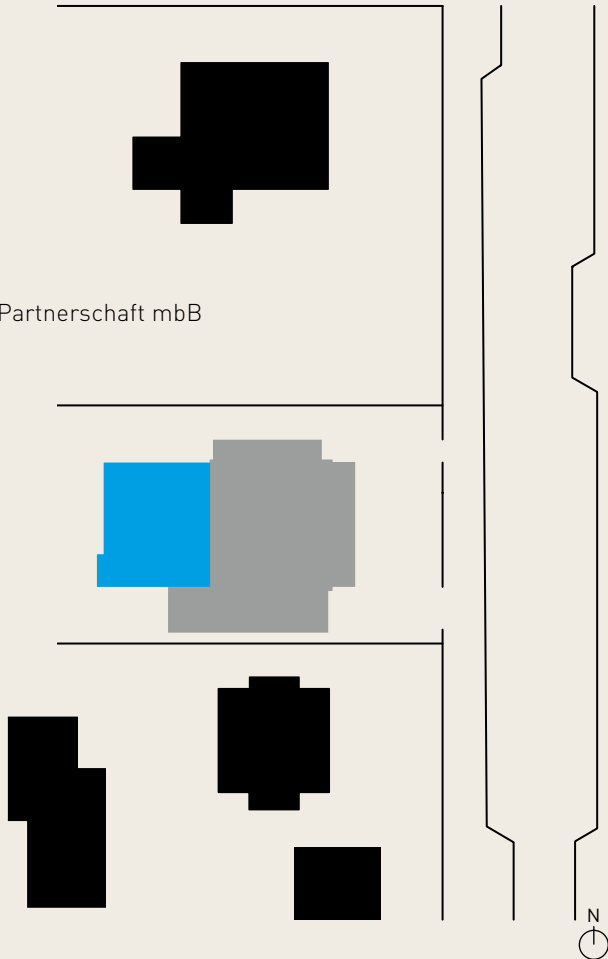

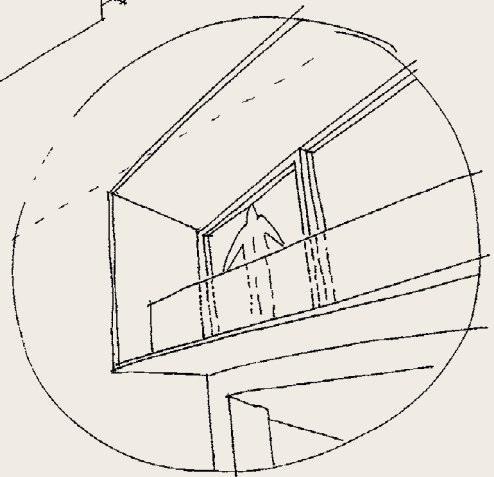
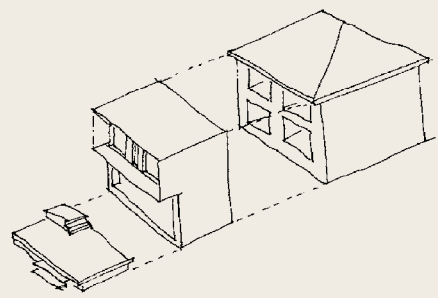
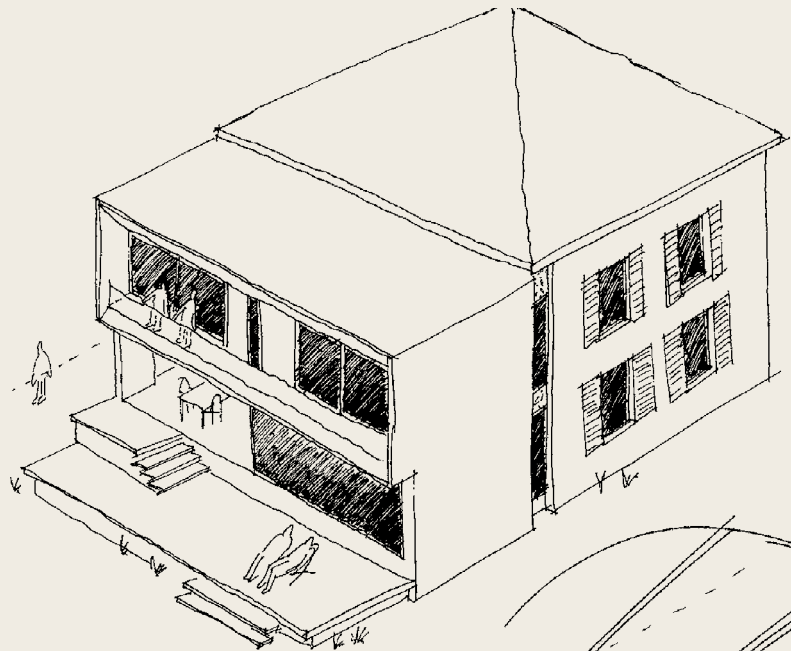

EG

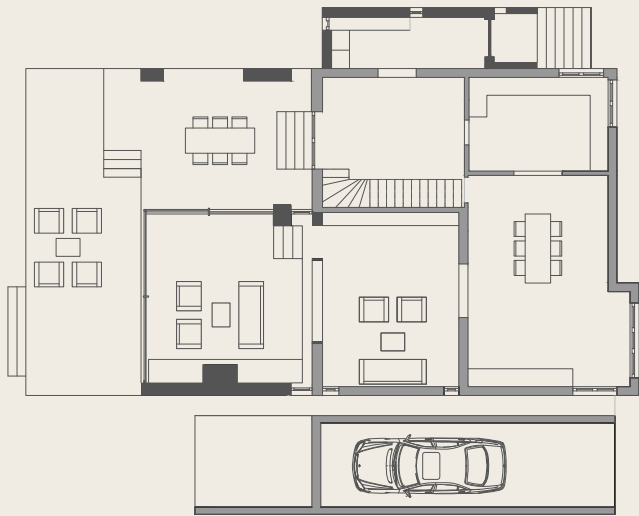

OG

